

Service Information



NAKAMICHI

Model Nakamichi 600 (2 Head Cassette Console)

Serial No. from 3839226

No. NR-0009 (1/3)

Date 20 July, 1977

Subject Modification of Reel Hub Ass'y

I. General:

A. Purpose:

Incomplete loading of a cassette tape can be found occasionally in previous models. In such a case, depressing the PLAY button will cause the cassette tape housing to touch on the R/P head and result in insufficient head base stroke.

The newly improved reel hub ass'y eliminates above trouble by adding the spring mechanism in the reel hub ass'y so as to sink the sprocket of reel hub ass'y when a cassette tape is loaded. Thus, complete loading of a cassette tape into the cassette case is possible.

B. Modification:

Previous Parts:

CA03268A Reel Hub T (B) Ass'y -- 1 pce.
CA03269A Reel Hub S (B) Ass'y -- 1 pce.

New Parts:

CA03300A Reel Hub C Ass'y -- 2 pcs.
OC03994A Supply Mylar Washer -- 1 pce.

C. Compatibility:

Possible. The new type of reel hub ass'y is compatible with the previous type.

II. Modification Procedures:

Replacement procedures for the new reel hub ass'y are discussed as follows:

1. Disassemble the Cabinet by removing five screws.
2. Disassemble the Front Panel by removing four screws and VR knobs.
3. Disassemble the Mechanism Ass'y by removing three screws and two connectors.
4. Remove the Cassette Case Ass'y and Cassette Lid Ass'y.
Referring to Fig. 1.1, remove F01 through F10 (Cassette Case Ass'y).
Referring to Fig. 1.2, remove F01 and F02 (both sides of Lid Springs) with pincers carefully.

5. Dismount both reel hubs of supply side and take-up side by removing the E-ring from the top of the reel hubs. Refer to Fig. 2. Then replace them with new reel hub assemblies.
6. Mount the Cassette Case Ass'y and Cassette Lid Ass'y.
7. Mount the Mechanism Ass'y and Connectors.
8. Load the Torque Gauge and check whether the take-up and rewind torques are in a range of 45 ± 10 g-cm and 35 to 60g-cm, respectively. If either torque is out of the range, adjust the torque by moving Reel Hub Spring, as shown in Fig. 3.
9. Measure the tape speed and wow/flutter and check whether the measured values are in their specified ranges. If these values are out of the ranges, re-adjustment or replacement of defective parts (including drive belt in wow/flutter measurement) will be required.
10. Mount the Front Panel and Cabinet.

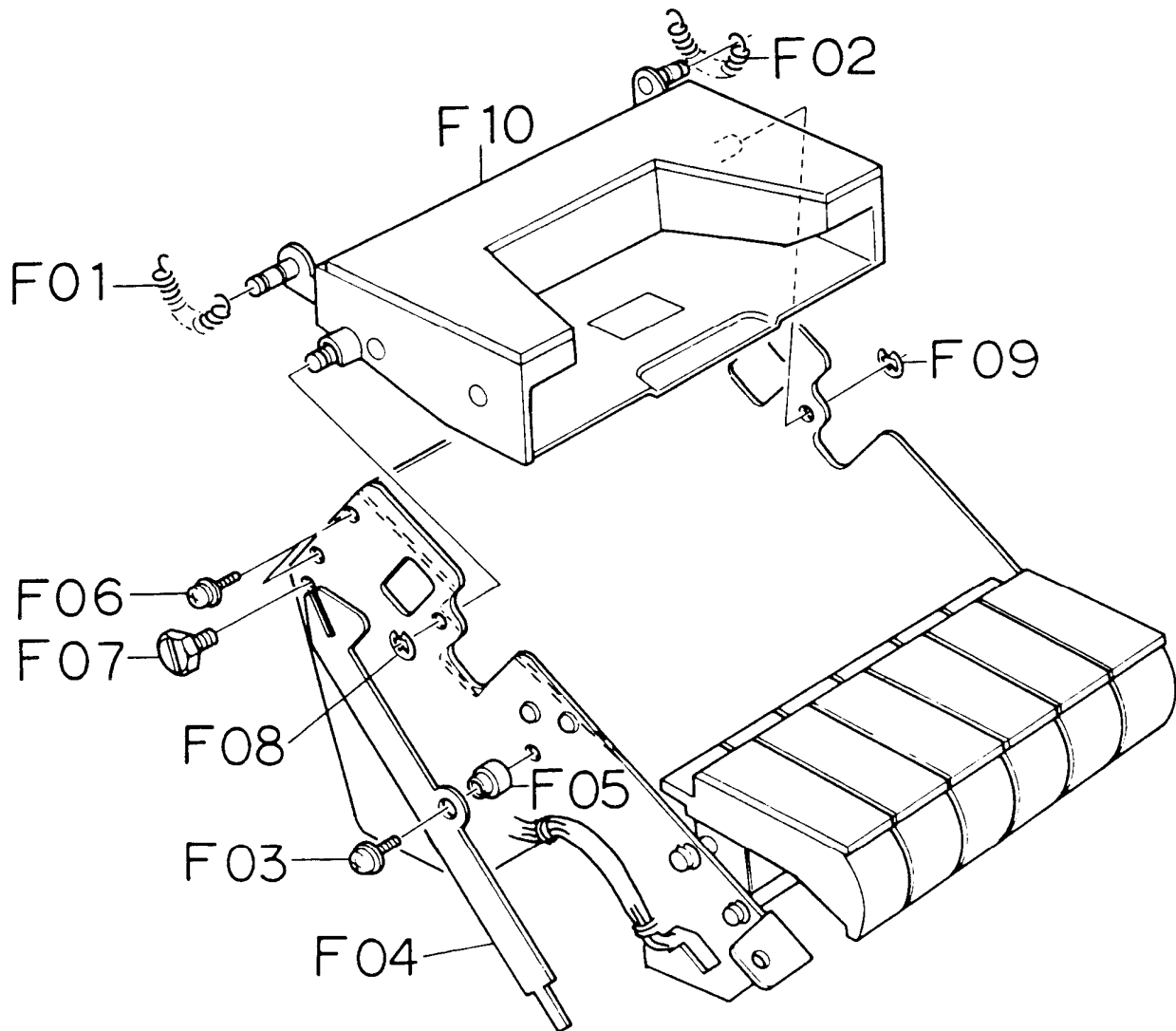

Fig. 1.1

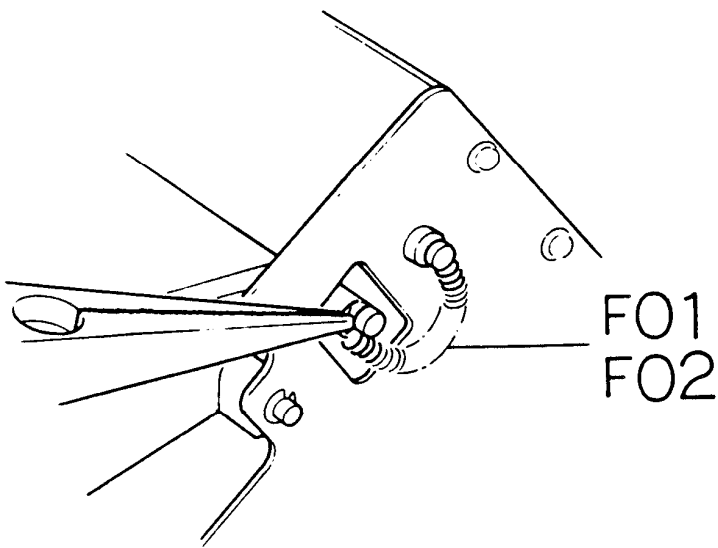

Fig. 1.2

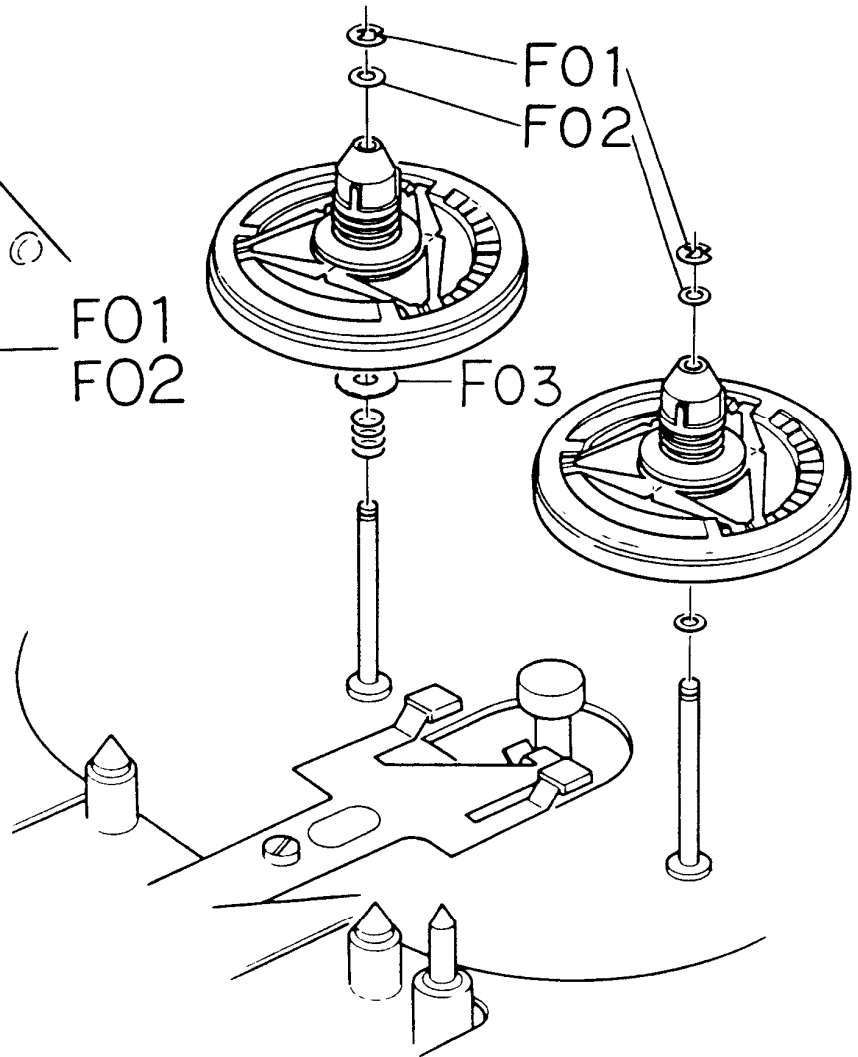

Fig. 2

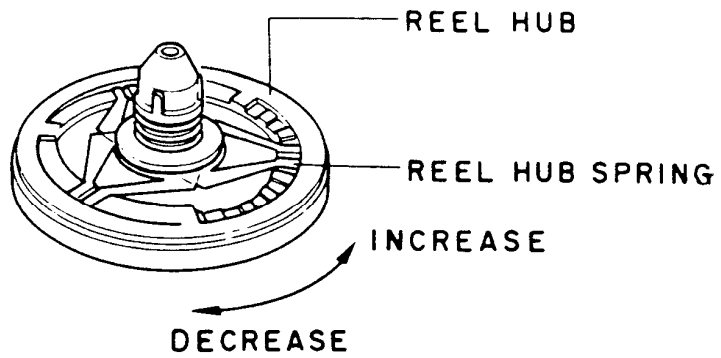

Fig. 3